



# Porch Construction Drawings

(may be used in conjunction with site plan for permit submittal)

Existing house

See Table A for allowable rafter size and spacing, allowable beam and post size, and allowable footing size.

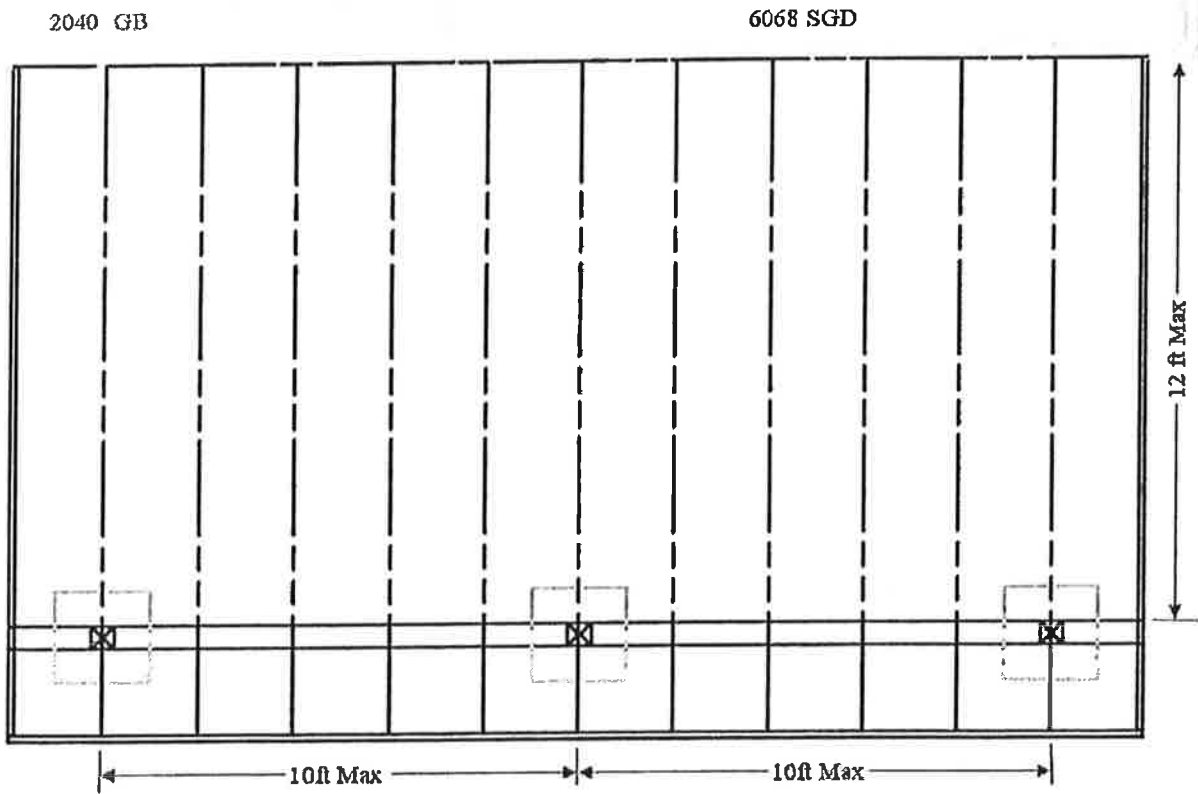

Rafter size and spacing: \_\_\_\_\_ Beam Size \_\_\_\_\_ Footing Size \_\_\_\_\_

Table A: <u>Porch Depth</u>	<u>Footing Size</u>	<u>Beam Size</u>	<u>Max Beam Span</u>	<u>Rafter Size</u>	<u>Post Size</u>
10ft	18" sq x 1' D	4x8	10ft	2x6 @ 24" o.c.	4x4
12ft	2' sq x 1' D	4x8	10ft	2x8 @ 24" o.c.	4x6

1. All construction shall comply with International Residential Code
2. All wood to be #2 Douglas fir or better

## Porch Framing Plan

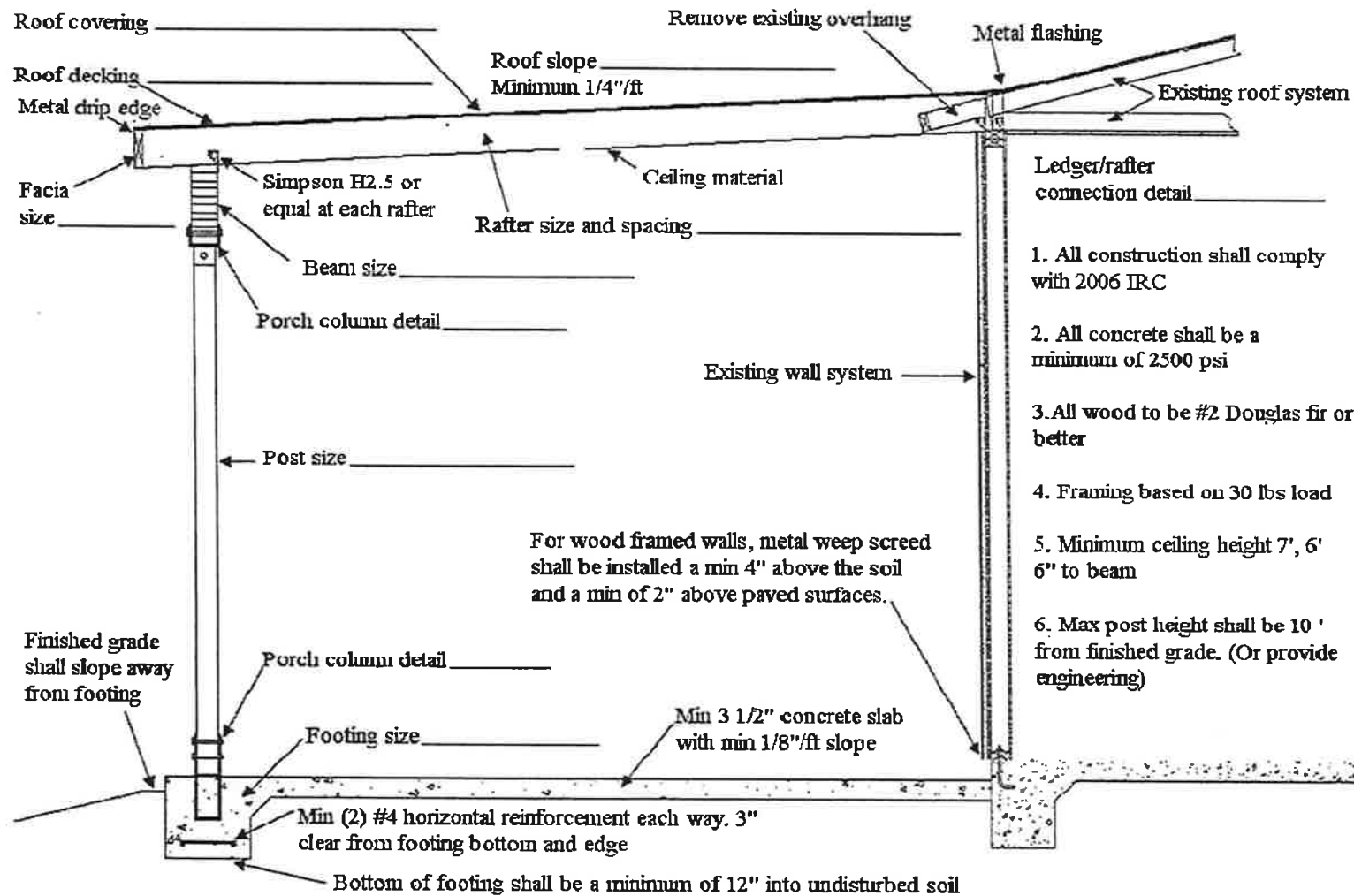

**Porch Section**

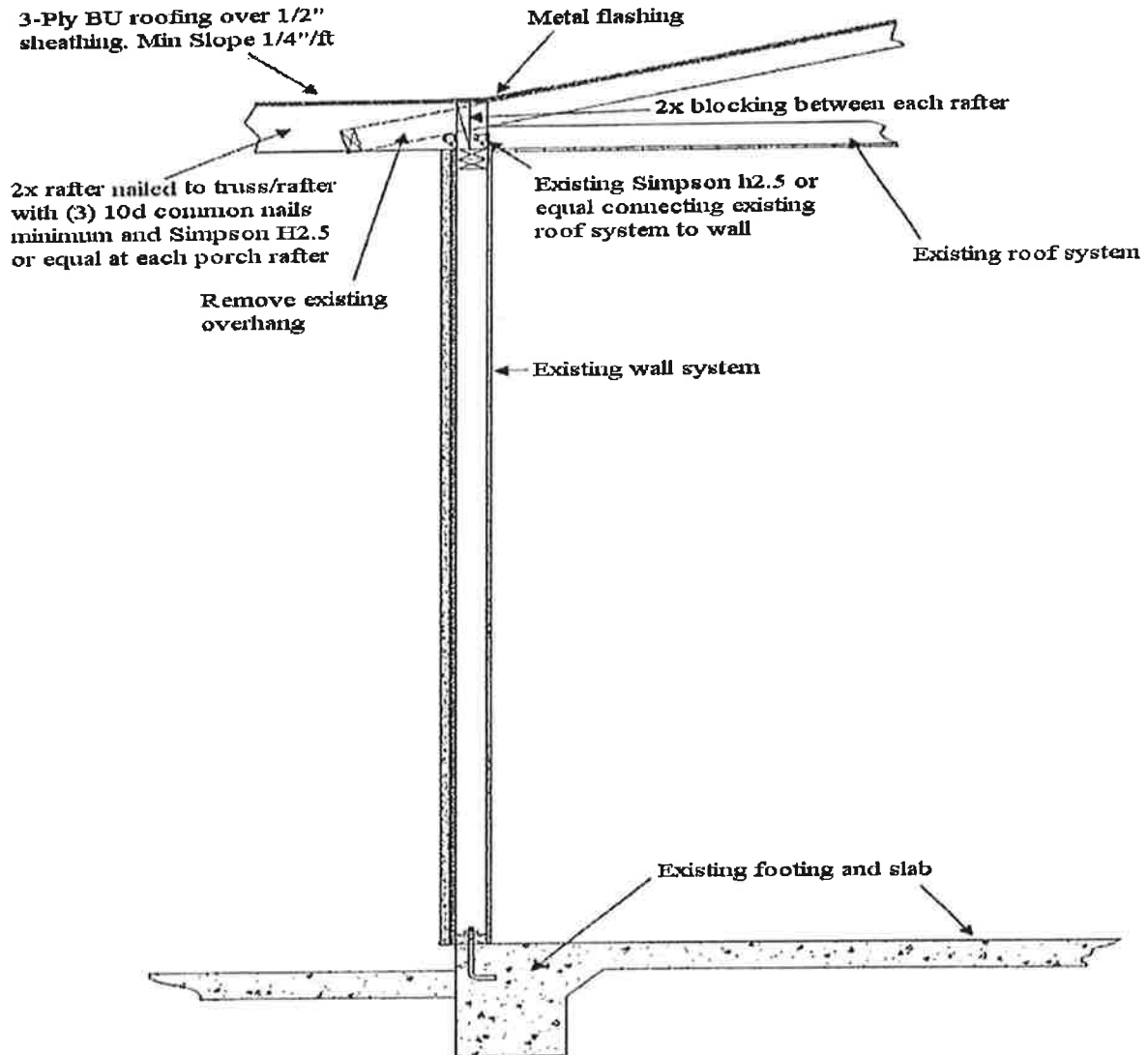

**Note:**

1. All construction shall comply with International Residential Code
2. All wood to be #2 Douglas Fir or better
3. Framing based on a 30 lbs load
4. Minimum Ceiling height shall be 7ft

**Detail A: Porch roof attachment to top of existing wall**  
(Not to Scale)

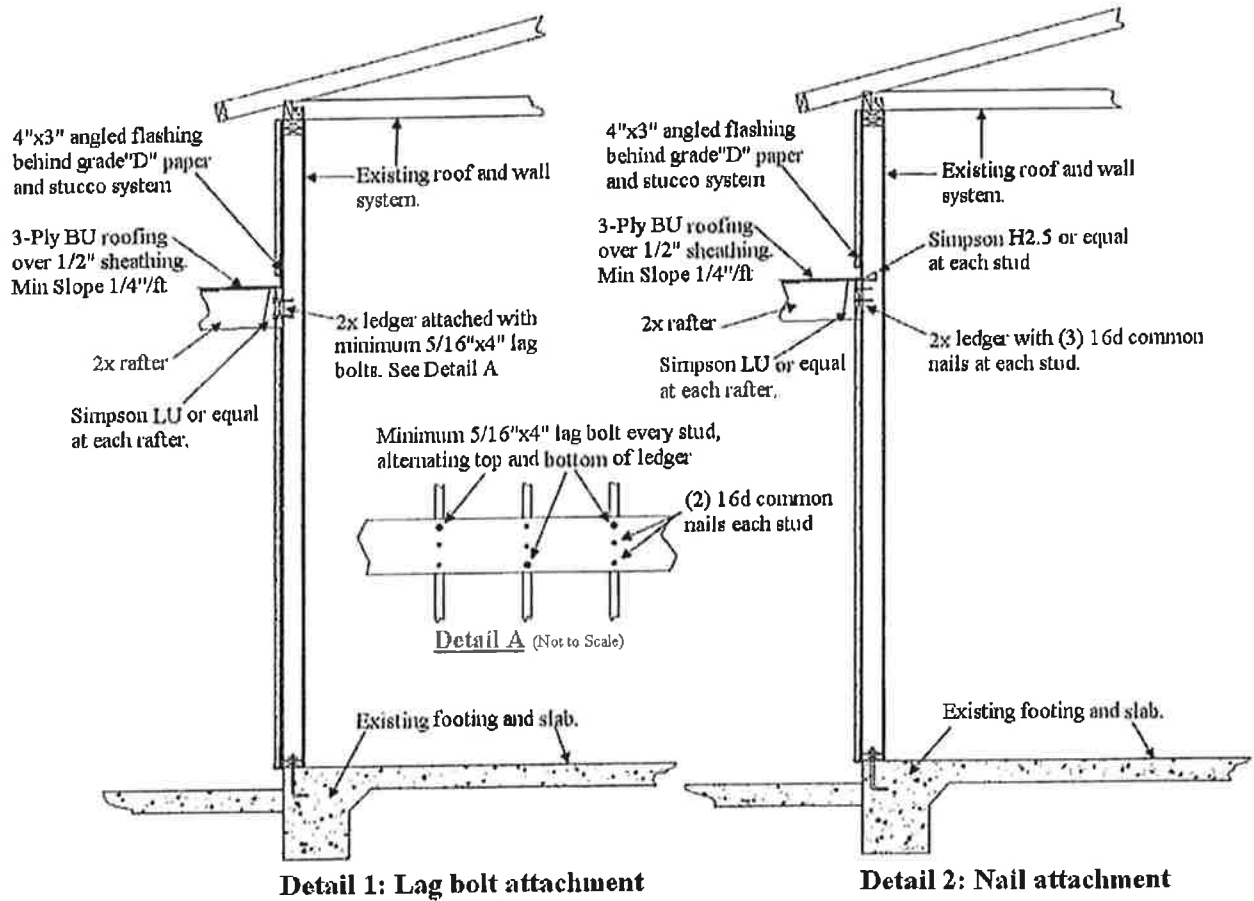

**Note:**

1. All construction shall comply with International Residential Code
2. Wood to wood connection required at ledger to stud attachment
3. All wood to be #2 Douglas Fir or better
4. Framing based on a 30 lbs load
5. Minimum ceiling height shall be 7 ft.

**Detail B: Wood Ledger Attachment to Wood Framing**  
(Not to Scale)

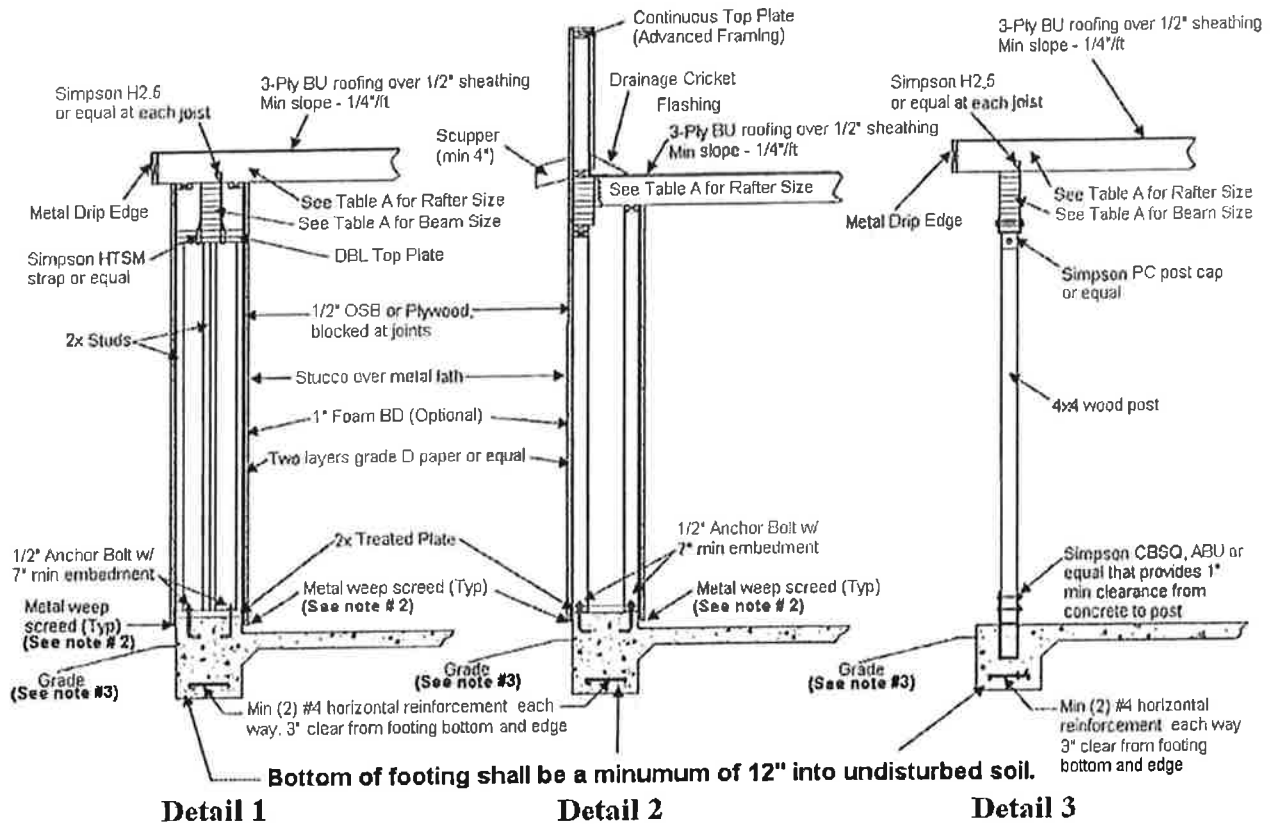

**Table A:**

Porch Depth	Footing Size	Beam Size	Max Beam Span	Rafter Size
10 ft	18" Sq x 1' D	4x8	10 ft	2x6 @ 24" o.c.
12 ft	2' Sq x 1' D	4x8	10 ft	2x8 @ 24" o.c.

1. All construction shall comply with International Residential Code
2. Metal weep screed shall be installed a min. 4" above the earth and a min of 2" above paved surfaces
3. Finish grade shall slope away from footing and be a min 6" from sill plate
4. All concrete shall be minimum 2500 psi
5. All wood to be Douglas Fir #2 or better
6. Framing based on a 30 lbs load
7. Minimum ceiling height 7 ft, 6ft-6inch to beam
8. Max height of column shall be 10' from finish grade. (Or provide engineering)

## Detail C: Wood Framed Porch Column

(Not to Scale)

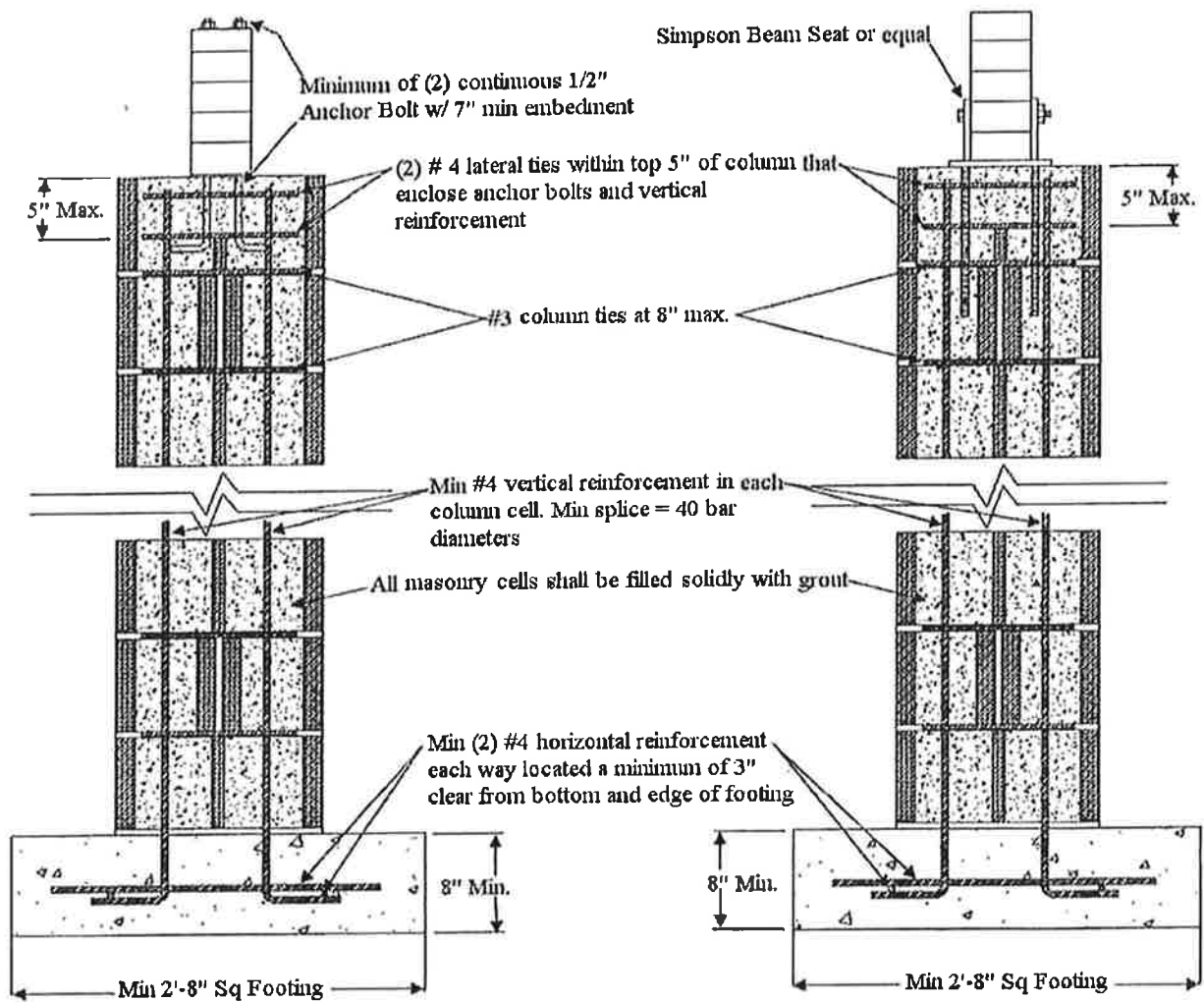

**Detail 1**

**Detail 2**

**Note:**

1. All construction shall comply with the International Residential Code
2. Bottom of footing shall be a minimum of 12" below undisturbed soil
3. All concrete shall be a minimum 2500 psi
4. Grout shall be concrete or Type M or S mortar
5. Max height of column shall be 10; from finished grade. (Or provide engineering)

**Standard Detail D: 16" x 16" Masonry Column**